

# DALI SONIK

## QUICK START GUIDE

SONIK 1  
SONIK 3  
SONIK 5  
SONIK 7  
SONIK 9  
SONIK ON-WALL  
SONIK CINEMA



IN ADMIRATION OF MUSIC

### 1. Pack Contents

SONIK	1	3	5	7	9	ON-WALL	CINEMA
Speaker(s) pr. carton	x 2	x 2	x 2	x 1	x 1	x 2	x 1
	x 2	x 2	x 2	x 1	x 1	x 2	x 1
	x 8						
	x 8	x 8	x 8	x 4	x 4	x 8	x 4
			x 8	x 4	x 4		
			x 8	x 4	x 4		
			x 4	x 2	x 2		
			x 1	x 1	x 1		
	✓	✓	✓	✓	✓	✓	✓

### 2. Position

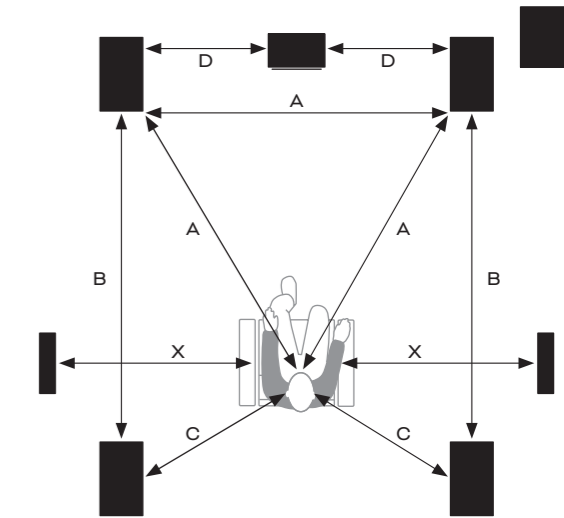
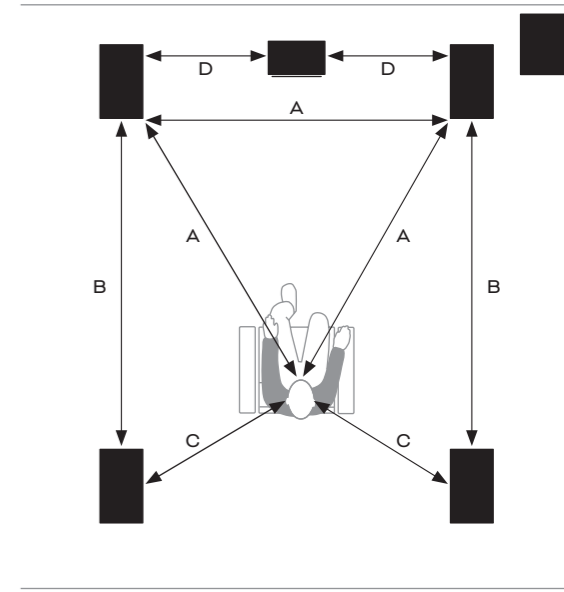
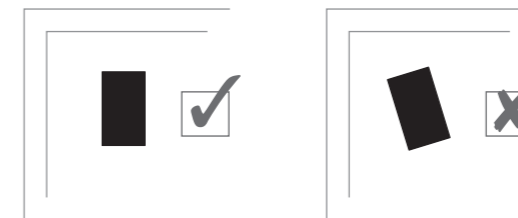
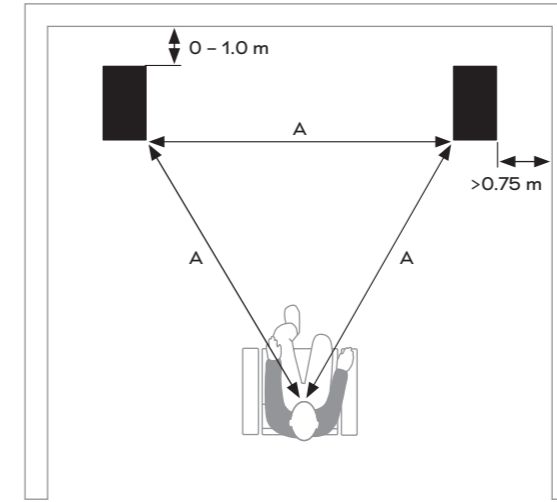

# DALI SONIK

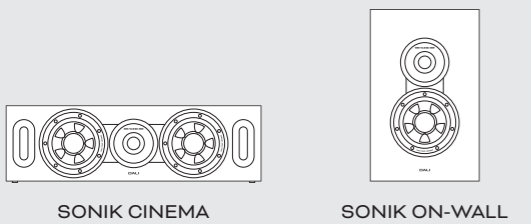
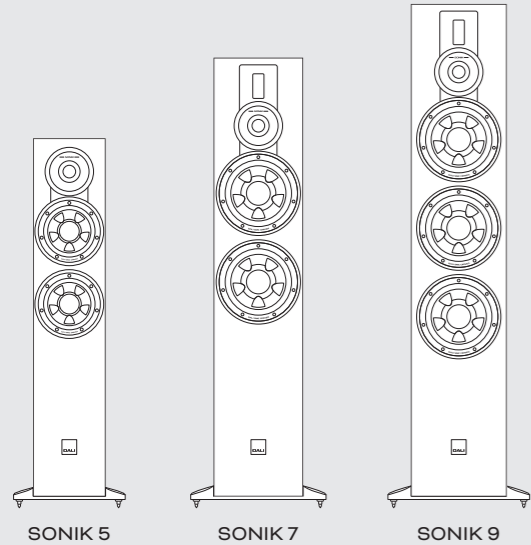
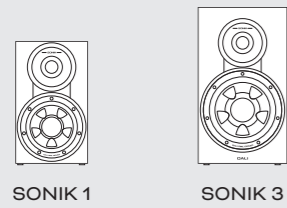

11-12-2025 ITEM NR. 051926-0-1

## 3. Mounting (stand/shelf)

SONIK 1  
SONIK 3  
SONIK CINEMA

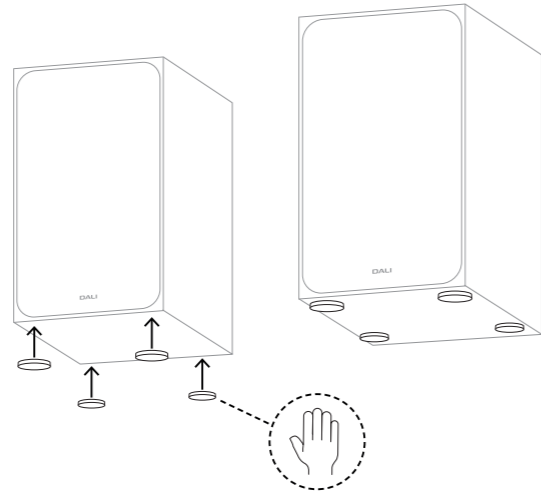

Remember to remove the dome protector

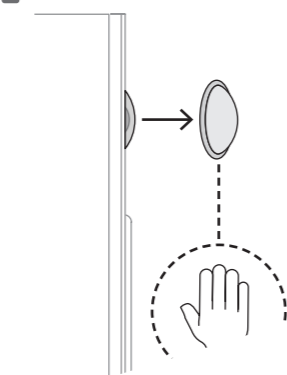

DALI SONIK  
User Manual

## 3. Mounting (wall)

SONIK 1

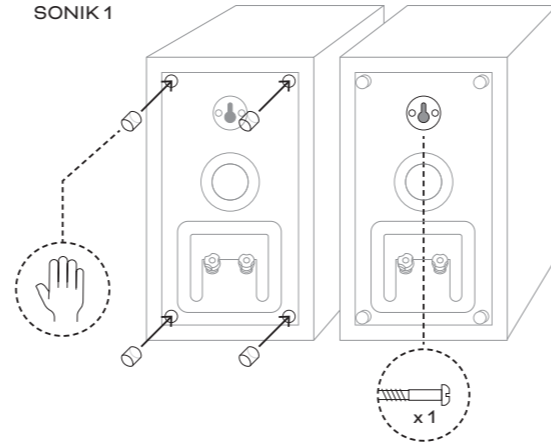

SONIK ON-WALL

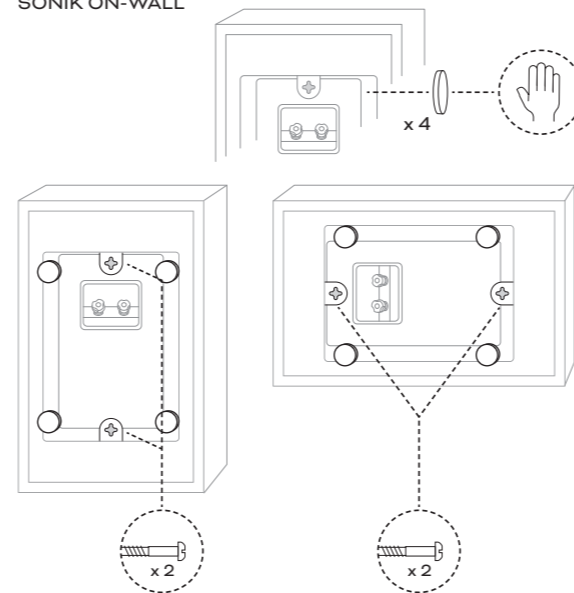

## 3. Mounting (floor)

SONIK 5  
SONIK 7  
SONIK 9

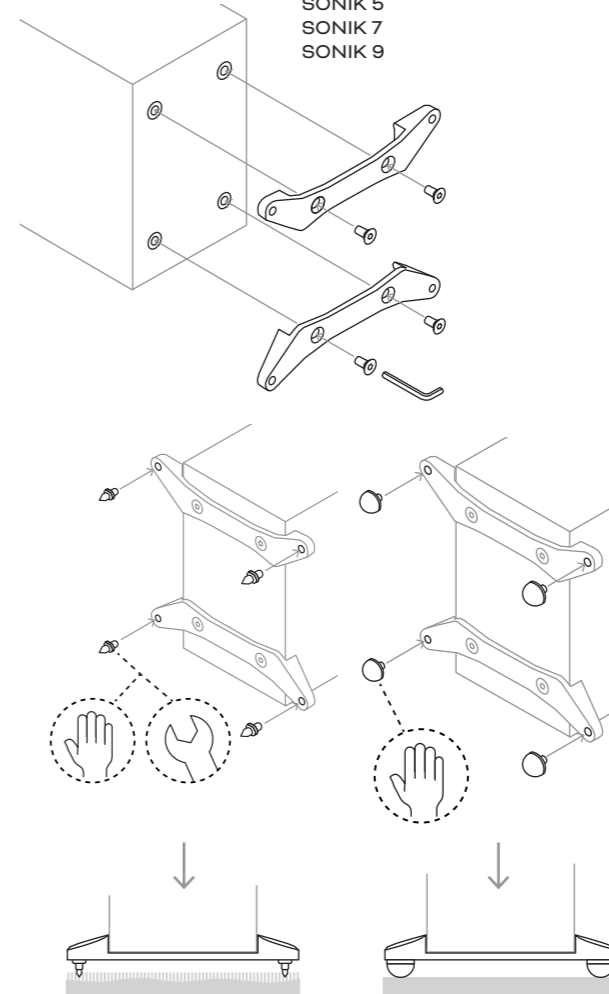

## 4. Wiring

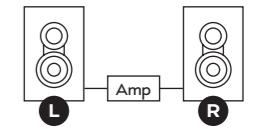
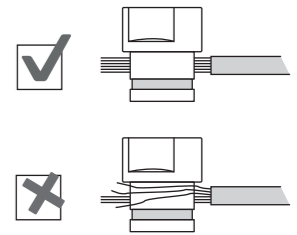

RIGHT  
speaker

LEFT  
speaker

